



## Mathews House

Tadros Court  
High Wycombe  
HP13 7GG

Monthly Rental Of £1,350

- Spacious Ground Floor Apartment
- Secure Undercroft Parking Space, Communal Gardens
- Popular Development Close to Town and Train Station
- Reception Hall, Open Plan Kitchen/Living Room
- Two Bedrooms, Bathroom and Ensuite Shower Room
- EPC Rating: C Council Tax Rating: C



T: 01494 358358

E: [lettings@wyeres.co.uk](mailto:lettings@wyeres.co.uk)

W: [www.wyeres.co.uk](http://www.wyeres.co.uk)

# Mathews House Tadros Court High Wycombe HP13 7GG

## PROPERTY FACTS

| Spacious & Exceptionally Well Presented Ground Floor Apartment | Easy Access to Town and Train Station | Communal Entrance with Security Entry System | Spacious Reception Hall | Open Plan Living Room & Modern Fitted Kitchen | Two Double Bedrooms | Modern Bathroom and Ensuite Shower Room | Double Glazing | Electric Heating | Secure Undercroft Parking | Landscaped Communal Gardens |

A well presented ground floor apartment in a popular development within walking distance of High Wycombe town centre and train station. The accommodation comprises; communal entrance hall with security entry phone, spacious hallway, open plan kitchen/living room, two large bedrooms, bathroom and ensuite shower, double glazing, electric heating, secure undercroft parking, landscaped communal gardens. Available on an unfurnished basis now.

## LOCATION FACTS

Tadros Court is a modern and highly sought after development situated to the east side of the town centre and within walking distance of High Wycombe Railway Station (London bound platform). The town centre offers an array of shops including supermarkets and hospitality venues including cinemas, gyms and restaurants.

## DIRECTIONS

From High Wycombe town centre proceed out along the A40 London Road and at the first roundabout turn left into Gordon Road. At the traffic lights turn right into Princes Gate and follow the road up the hill taking the first turning left. Proceed over the railway bridge and take the first turning right into Tadros Court and follow the road down where Mathews House can be found on the right.

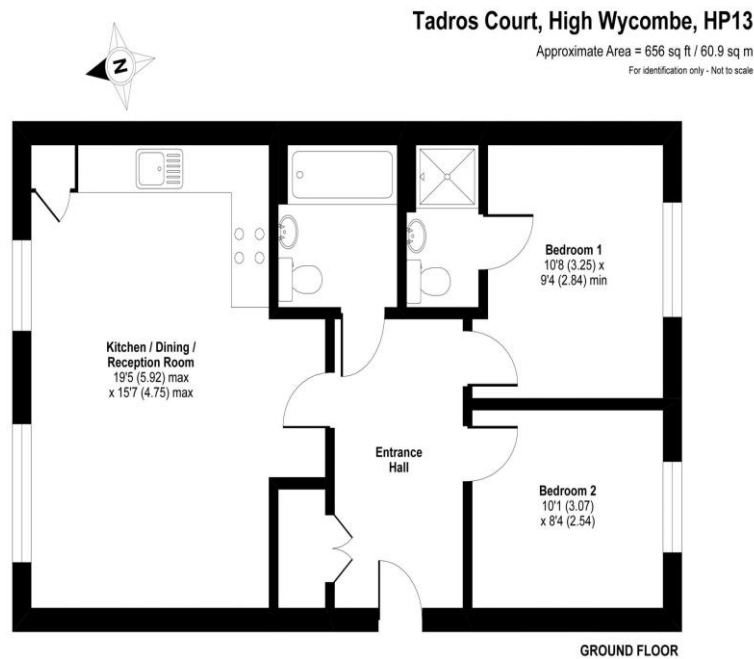

 Floor plan produced in accordance with RICS Property Measurement Standards incorporating International Property Measurement Standards (IPMS Residential). ©richcom 2021. Produced for Wye Residential LLP. REF: 896491

